

# KG1302-01 Connection Board

2013.10

## ■ Adapted Sensor

Type	KG1302-01
------	-----------

## ■ Pin Assignment

No.	Function
1	Vcc
2	+A
3	-A
4	+B
5	-B
6	Z
7	GND

## ■ Board

Material	FR-4
Thickness	1.2mm
Electrode	Au

## ■ Dimension

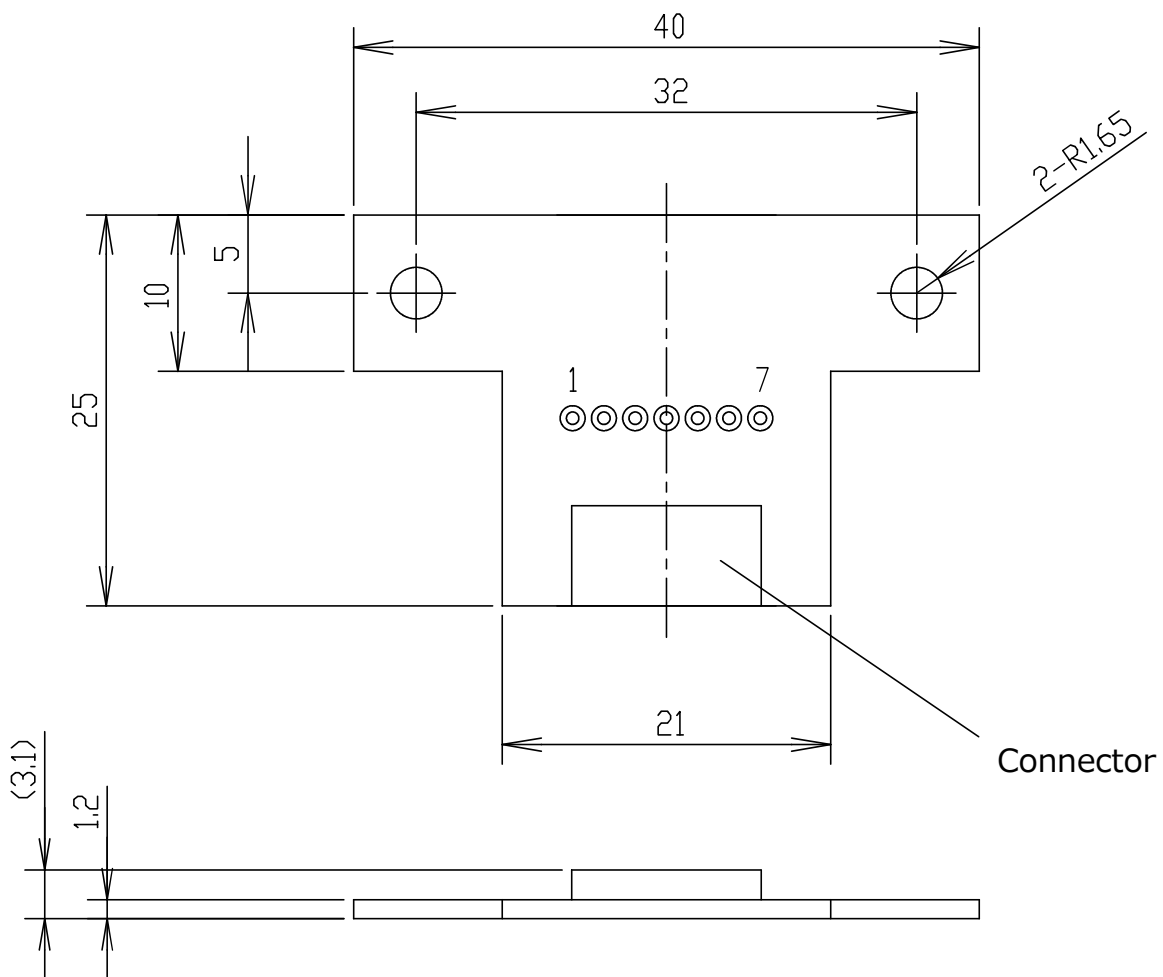

Connector: JAE IL-FPR-U11S-HF-N1

Unit  
mm